



**ELIZABETH LINE**

**Welcome to the  
Elizabeth line**

**MAYOR OF LONDON**



**TRANSPORT  
FOR LONDON**  
EVERY JOURNEY MATTERS

# Continuing your journey on the Elizabeth line at Paddington

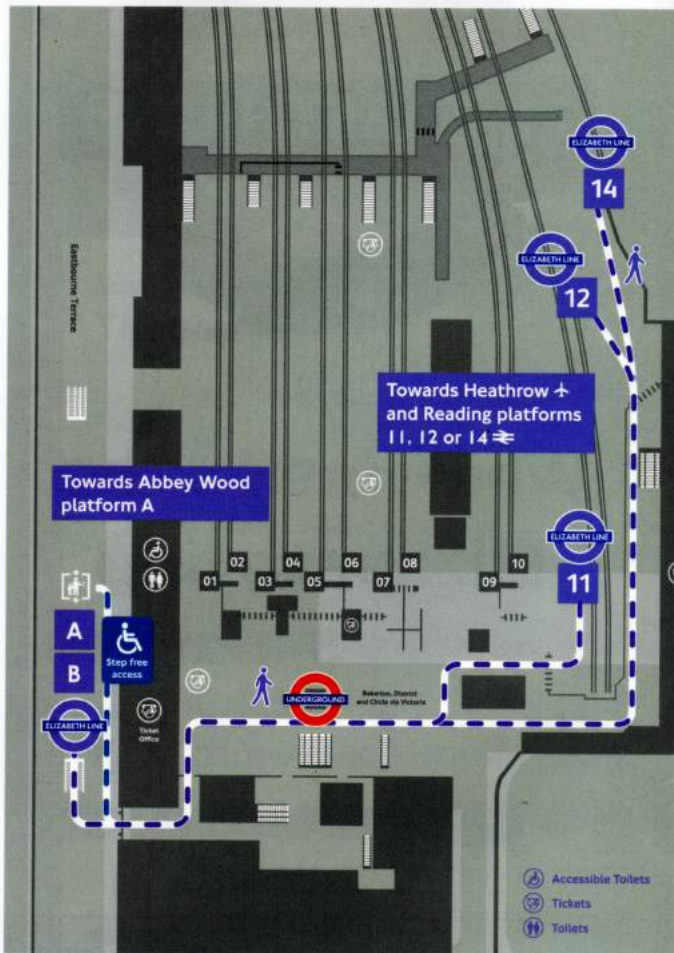

## Paddington

Elizabeth line services towards Heathrow ✈️ and Reading depart from Paddington National Rail platforms 11, 12 or 14 ➡️

Elizabeth line services towards Abbey Wood via Central London depart from platform A

# and Liverpool Street.



## Liverpool Street

Elizabeth line services towards  
Shenfield depart from Liverpool Street  
National Rail platforms 15 - 17 ➡

Elizabeth line services towards  
Paddington and Abbey Wood depart  
from platforms A & B

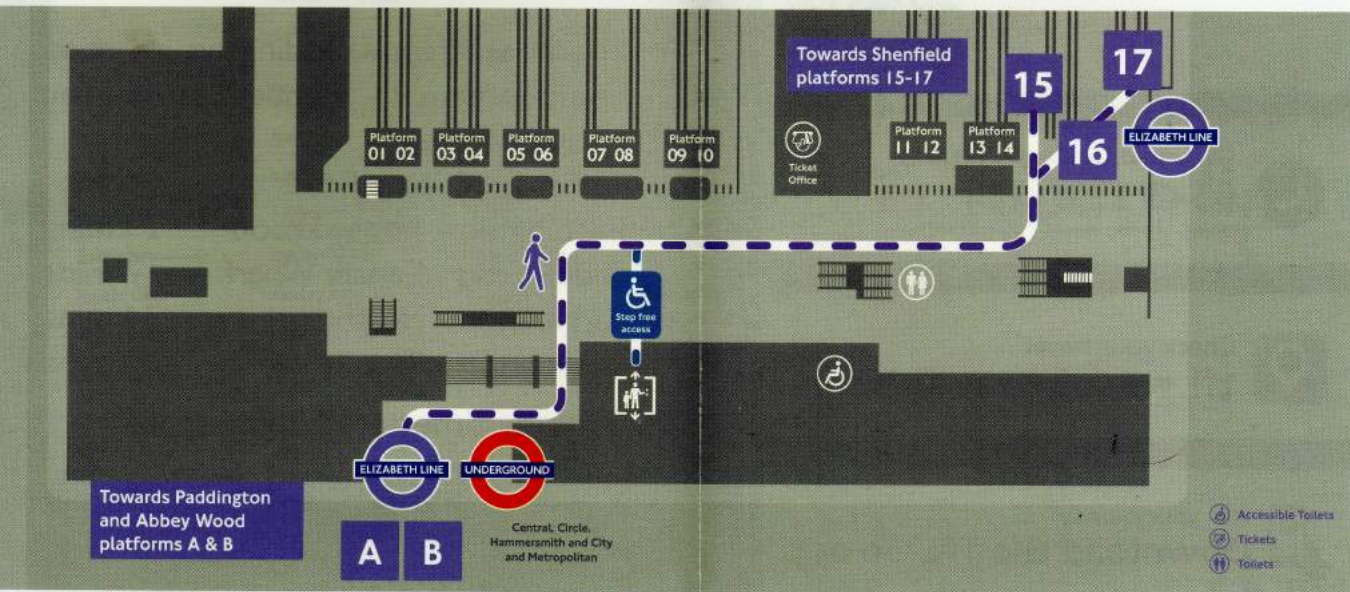

- Accessible Toilets
- Tickets
- Toilets

# Travel information

## Oyster

Oyster cards are accepted for journeys made within fare zones 1-9, please note Iver to Reading stations are located outside of fare zones and Oyster cards are not accepted.

Contactless can be used across the entire Elizabeth line. )))

For more information about fares please visit: [tfl.gov.uk/fares](https://tfl.gov.uk/fares)

Scan QR codes for  
**Timetables**



**Customer Contact Centre**

**0343 222 1234\***

\*Network charges may apply. See [tfl.gov.uk/terms](https://tfl.gov.uk/terms) for details.



Check your travel

**[tfl.gov.uk/travel-tools](https://tfl.gov.uk/travel-tools)**



Plan your journey

**Download the TfL Go app**

# Looking to the future of the Elizabeth line

The next phases of opening the Elizabeth line will integrate services from the east and west into the new central tunnels and stations bringing additional benefits to those travelling to and from the east and west. This connection brings the three railways together and enables services from Reading and Heathrow through to Abbey Wood and Shenfield.

## Journey times

Liverpool Street - Paddington	11 mins
Liverpool Street - Shenfield	43 mins
Liverpool Street - Tottenham Court Road	6 mins
Paddington - Abbey Wood	29 mins
Paddington - Canary Wharf	17 mins
Paddington - Heathrow	34 mins
Paddington - Reading	60 mins

Journey times are approximate.

# Accessibility



## Elizabeth line level access guide

Boarding areas are marked in the middle of all platforms



### Step-free access from train to street

Elizabeth line platforms at these stations have level access from train to street.

**Bond Street**  
Opening soon

**Canary Wharf**

**Custom House**

**Farringdon**

**Heathrow** †  
All Terminals

**Liverpool Street**  
Elizabeth line Station

**Paddington**  
Elizabeth line Station

**Tottenham Court Road**

**Whitechapel**

**Woolwich**



### Step-free access from platform to street

Elizabeth line platforms at these stations require a boarding ramp from train to platform.

Before you board the train here, request a ramp for the station where you plan to get off by pressing the information button on any Help Point or speaking to a member of staff.

**Abbey Wood**

**Acton Main Line**

**Brentwood**

**Burnham**

**Chadwell Heath**

**Ealing Broadway**

**Forest Gate**

**Gidea Park**

**Goodmayes**

**Hanwell**

**Harold Wood**

**Hayes & Harlington**

**Ilford**  
Step-free coming soon

**Iver**

**Langley**

**Liverpool Street**  
National Rail Station

**Maidenhead**

**Manor Park**

**Maryland**

**Paddington**  
National Rail Station

**Reading**

**Romford**

**Seven Kings**

**Shenfield**

**Slough**

**Southall**

**Stratford**

**Taplow**

**Twyford**

**West Drayton**

**West Ealing**