

THORN EMI

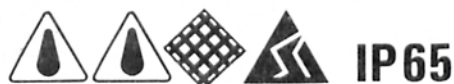

Installation and Wiring Instructions for SON-PAK 7 OT 70.T Mk11

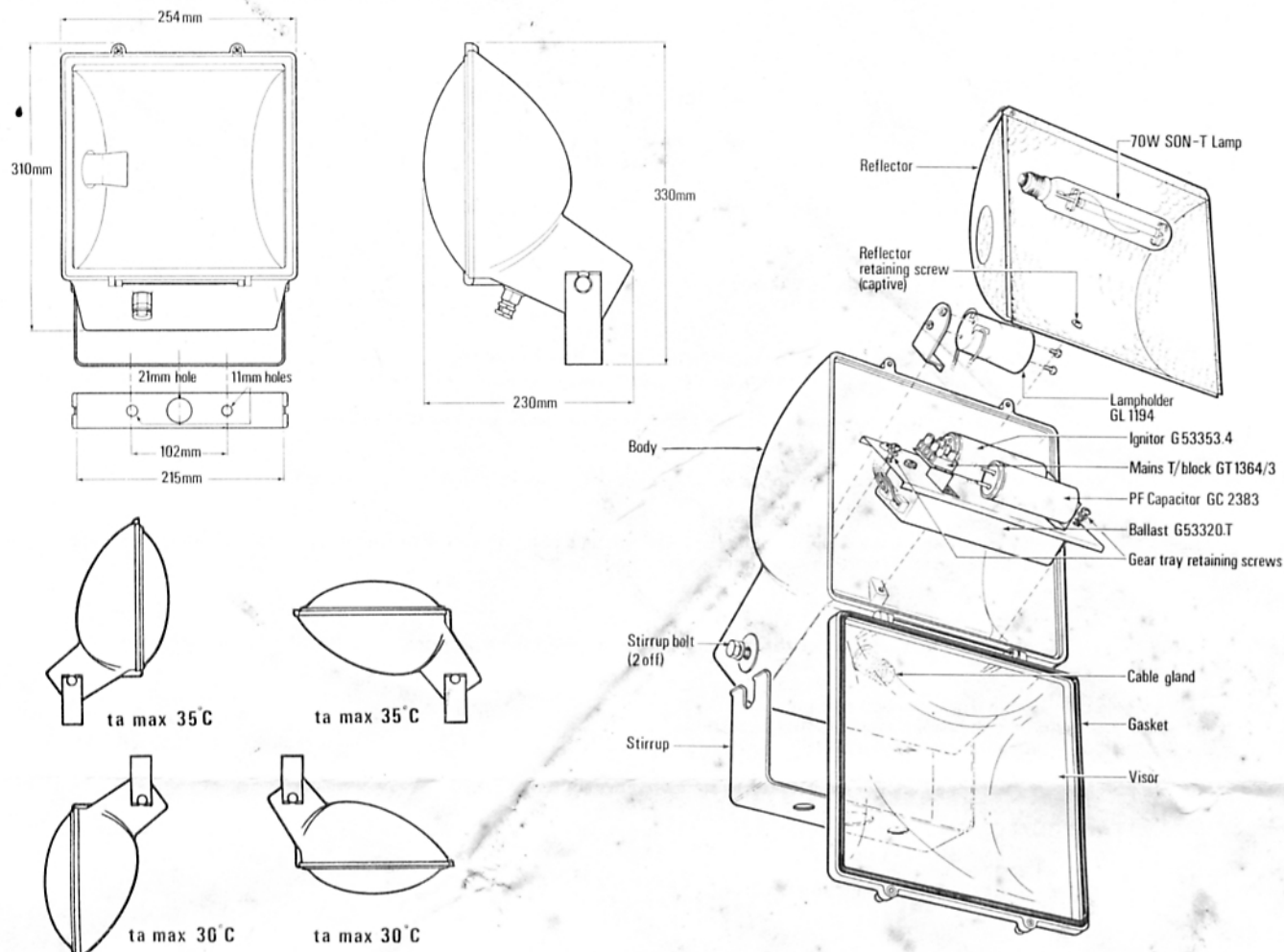

INSTALLATION AND MOUNTING

(Note: The maximum operating ambient temperature for the fitting is dependent on the mounting position of the lamp relative to the control gear as follows: Ballast above lamp 30°C Ballast below lamp 35°C) — see diagrams for explanation.

1. Remove stirrup from fitting by loosening retaining bolts.
2. Mount stirrup in selected position using one of the mounting accessories shown below.

Note: Stirrup can be directly wall mounted although no horizontal adjustment of the fitting is then possible.

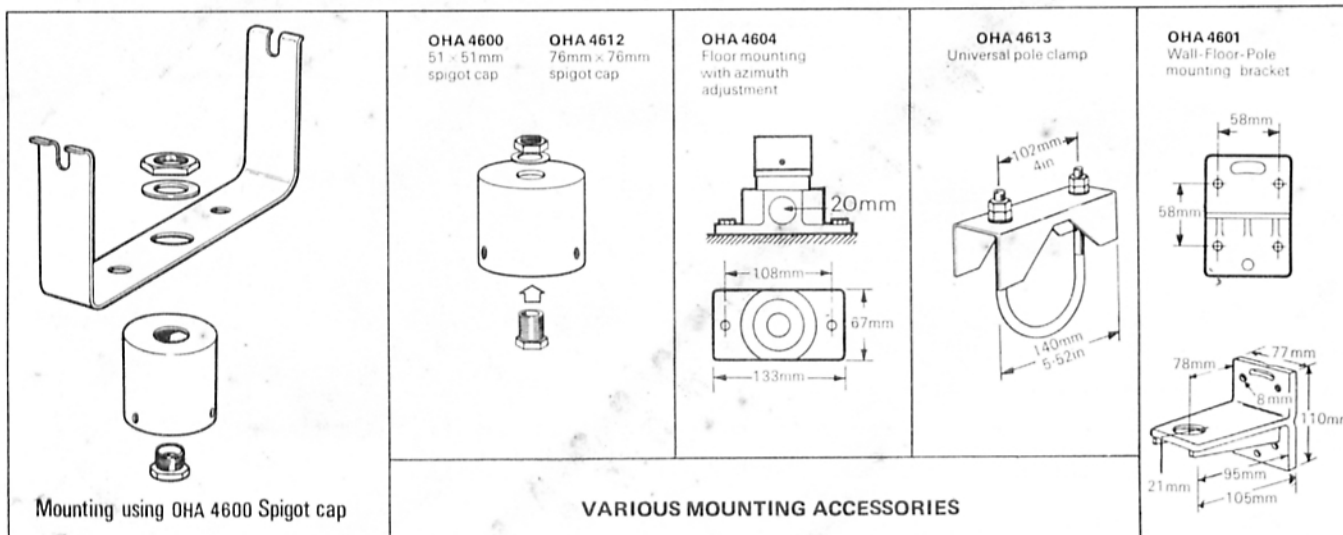

3. Relocate fitting in stirrup ensuring that fibre washers are situated between the stirrup and fitting body.
4. Aim fitting and tighten down stirrup bolts.

WIRING INSTRUCTIONS

(Note: The supply cable terminations can operate in excess of a temperature of 70°C when the luminaire is operated in an ambient temperature exceeding 25°C. Guidance should be sought from BS 6500 regarding suitable cables for use at these higher ambients.

1. Unscrew the two captive screws holding the visor in position and hinge forward.

Note: The visor may be completely removed if required by carefully levering a screwdriver between the fitting body and one of the visor hinges. For replacement locate one hinge back onto its hinge pin and position the other hinge slot adjacent to its hinge pin. Gently close the visor and it will snap back into position.

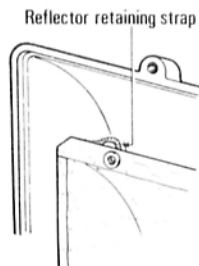
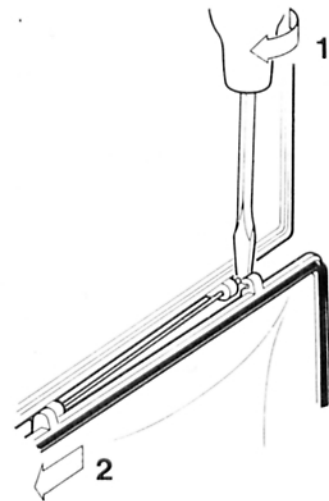

Illustration showing braided wire holding reflector to fitting

Removing Visor (if necessary)



2. Loosen the reflector retaining screw and carefully ease the reflector out of the fitting body and move to one side.
3. Loosen the 2 screws on the combined cable gland/clamp, pass a 3 core cable /maximum outside diameter 9mm) into the fitting and make connections to terminal block.
4. Tighten cable gland and clamp to hold cable firmly in position and prevent moisture entering the fitting.
5. Replace reflector and tighten retaining screw.
6. Insert lamp into lampholder.
7. Hinge the visor back into position and screw the 2 visor retaining screws down securely to create a weatherproof seal.

Test for insulation and continuity before switching mains supply on.

DO NOT megger test the fitting as serious damage will be done to the electronic components employed within the ignitor housed on the gear tray. The mains supply must be disconnected before any servicing is carried out.

GEAR TRAY REMOVAL

If a fault is suspected on the gear tray, first disconnect the mains supply and then follow sections 1 and 2 under 'Wiring Instructions' to gain access to gear tray.

1. Remove incoming mains cable from terminal block.
2. Unscrew the screws holding the lampholder bracket in position.
3. Remove the 2 screws holding the gear tray in position.

The complete assembly together with the lampholder can now be removed for fault diagnosis.

CLASSIFICATION FOR PROTECTION

Against electric shock: Class 1 earthed metal work.

Against ingress of moisture or dust: IP 65 Dust-tight and Jet proof.

COMPLIANCE WITH BS 4533

This luminaire complies with BS 4533:2.5.

Luminaires for which Safety-Mark approval has been granted by the British Standards Institution are identified by a suitable label on the product.

CIRCUIT DIAGRAM

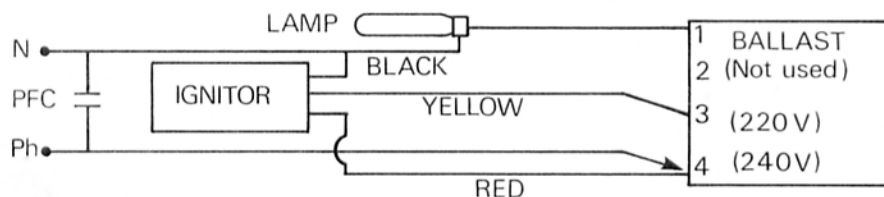

LAMP TYPE 70W SON-T

SPARE ITEMS:

Ballast	G 53320.T
Power Factor Capacitor	GC 2383
Ignitor	G 53353.4.
Terminal Block	GT 1364/3
Lampholder	GL1194

FUSING

The recommended fuse ratings for a single fitting are 4A HRC or 5A re-wireable. Where a multiple number of fittings are to be operated from a single fuse, recommended values can be found in data sheet L36/T.

ELECTRICAL CHARACTERISTICS

For further information on the control gear used in this fitting and the running conditions for the circuit refer to data sheet G9B.

The right is reserved to change specifications without prior notification or public announcement.

Made in the United Kingdom